



Riviera 2" Blind

Installation Instructions

Thank you for purchasing a Riviera 2" Blind. You can take pride that your purchase will add beauty and function to your home.

Please read the American Window Covering Manufacturers Association Warning included in these instructions. You will also find a warning tag attached to the lift cord and a permanent label on the bottom rail of your Riviera blind. For your safety and the safety of others, do not remove the permanent label and keep these installation instructions. This insures that future owners of this Levolor product are aware of the potential dangers associated with children playing with blind cords.

IMPORTANT

Please complete and return the enclosed warranty pamphlet. Retain the warranty information on the front panel for your records.

1. Check All Hardware

Be sure you have all components identified in Diagram A.

Tools you will need

- Phillips screwdriver or 1/4" hex driver
- Hand or electric drill with 1/16" drill bit
- Pencil
- Tape measure

When using tools, make sure you have proper eye protection. Never use tools while under the influence of alcohol or other drugs.

Choose the proper fastener

For installation in wood or aluminum window frames, Levolor recommends using the sheet metal screws included with your Riviera blind. For other types of wall construction, you will need to furnish different fasteners.

Fastener options (Diagram B, from left):

- #8 screws for wood or aluminum
- Plastic inserts for drywall or plaster
- Auger threaded zinc or plastic inserts for drywall
- Molley bolts for plaster
- Toggle bolts for lath & plaster

Step 2. Attach the brackets

Installing end brackets: Determine where to attach each bracket. There is a left bracket (Diagram C), and a right bracket (Diagram D). For outside mounting (Diagram E), position bracket on the window frame and attach with proper fasteners. For inside mounting (Diagram F), position top of bracket against inside surface of window frame and attach as shown. Each end bracket uses two screws mounted diagonally. Make sure end brackets are level.

Installing support brackets (where supplied): Center the support bracket between the two end brackets. Keep the top and back of each support bracket level and aligned with tops and backs of end brackets. If more than one support bracket is used, space the support brackets evenly across the width of the headrail. Insert screws in the top for an inside mount; insert screws in the back for an outside mount (Diagram G).

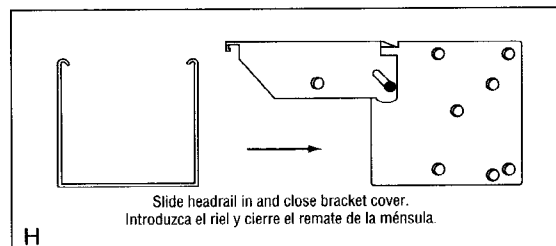
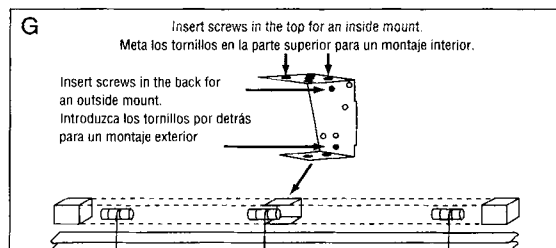
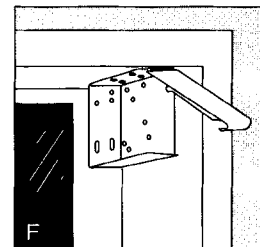
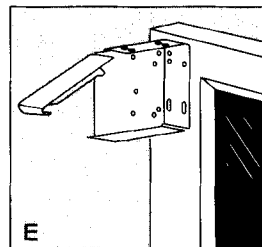
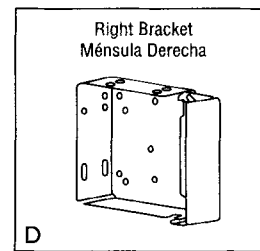
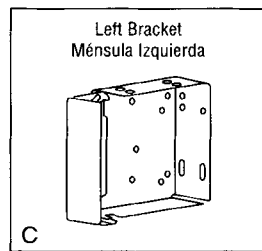
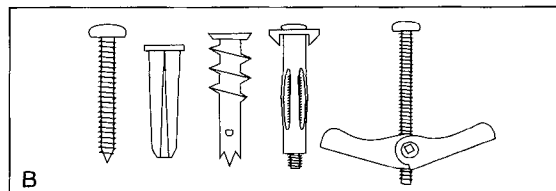
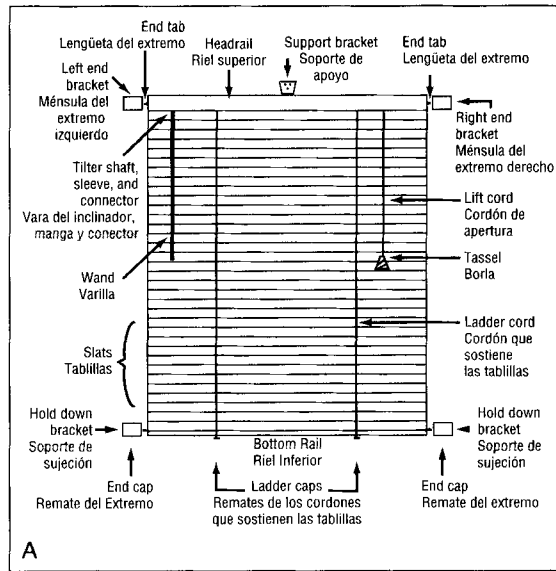

Step 3. Install the Headrail

Insert the headrail into the end brackets by opening both end bracket covers (Diagram H) and sliding the headrail into the end brackets and support bracket(s). Then close end bracket covers until they click into place (Diagram I).

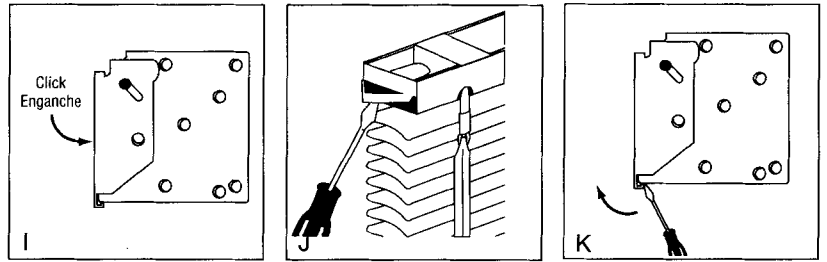

Step 4. Adjust Headrail Fit

The headrail should fit end brackets tightly. To adjust, bend out the tab on each end of the headrail (Diagram J) until a snug fit is achieved. After adjusting the fit, replace headrail as described above in Step 3. To remove the headrail, rotate the bracket cover up (Diagram K). (You may have to use the tip of a screwdriver to push the cover open.)

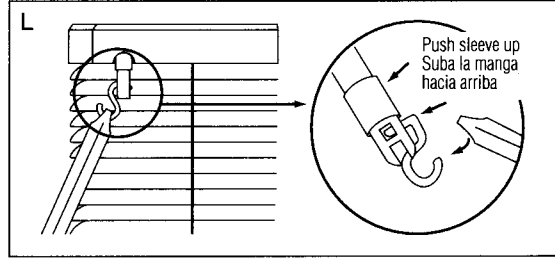

Step 5. Attach the tilt wand

Push the tilt wand sleeve up (Diagram L), engage the S-hook as shown, then pull sleeve down (Diagram M). Rotate the tilt wand to open and close blind slats. Use the pull cord to raise and lower blind.

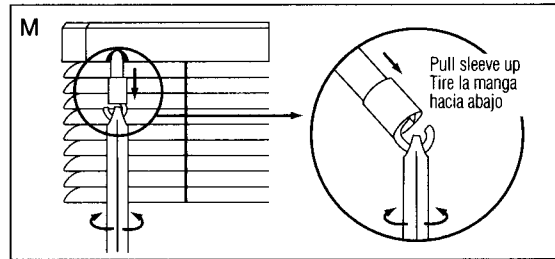

Step 6. Install Vogue® Valance - Inside mounting

Your Riviera blind includes a single slat valance. The valance frame attaches to the valance clip, and the valance clip snaps over the edge of the headrail (Diagram N). Be sure the valance clips are spaced evenly along the length of the valance frame.

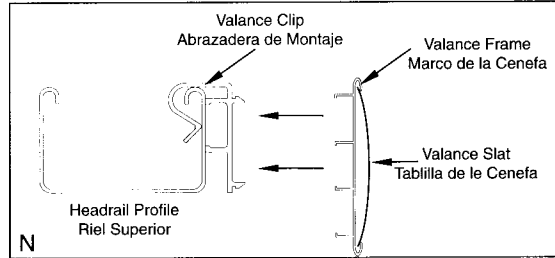

Step 6. Install Vogue® Valance - Outside mounting

Riviera blinds ordered as an outside mount are supplied with a valance, 2 corners and 2 return pieces fully assembled. The valance is shipped flat. To form the corner, hold frame and return piece firmly while bending down over table edge to form a 90° angle. Corner will lock into position (Diagram O). Continue as described under Inside Mounting. Valance returns are designed to cover the size of the installation bracket. Returns may be trimmed with a scissors, if necessary, to shorten (Diagram P).

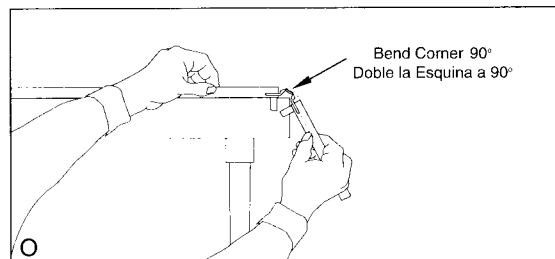

Step 7. Install Hold Down Brackets (Optional)

For an inside mount, attach bracket to bottom surface (Diagram Q). A side view of the hold down pin snapped into the hold down bracket is shown in Diagram R.

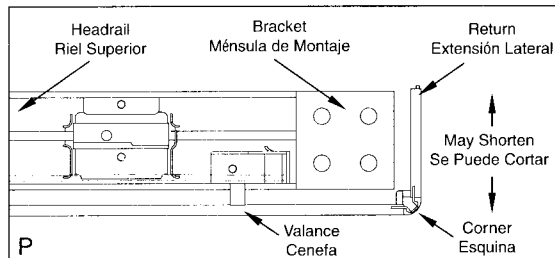

For an outside mount, attach bracket to wall or window frame (Diagram S).

Cleaning Instructions

Keep your Riviera blind looking its best by periodically wiping it with a soft cloth, a dusting mitt, or the round brush attachment from a vacuum cleaner.

- You can clean the blind hanging in place or you can take it down.
- By tilting the slats down, but not quite closed, you'll be able to clean most of the top surface of each slat.

In very dusty environments, you may need to use a sponge or dampened soft cloth to clean the blind.

- Use warm (not hot) water and a mild detergent. The mild detergent cannot contain abrasives.
- Rinse the blind with clean water to prevent water spots.
- Place a towel on the floor or window sill to absorb any water that might drip from the blind.

Please note that certain solutions and equipment are too harsh and can cause shrinkage and/or color damage to your blind. The Levolor Forever Never Worry Warranty does not cover damage caused by cleaning methods that use abrasive solutions.

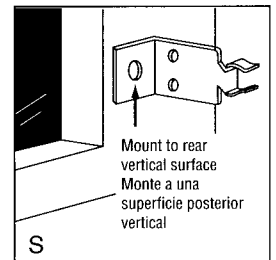
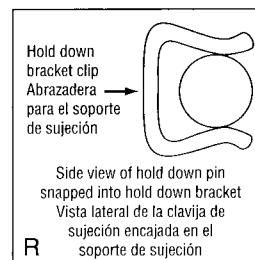



**DANGER
STRANGULATION
HAZARD**

**PELIGRO
DE ESTRANGULACIÓN**

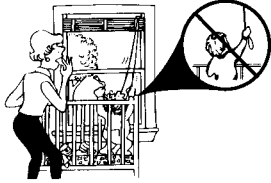

**Keep cords out of the reach of children
Mantenga los cordones fuera del alcance del niño**

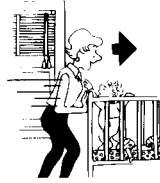

**Move cribs and furniture away from cords
Separe las cunas y los muebles de los cordones**

**Remove objects below windows
Remueva los muebles y objetos que están debajo de las ventanas**

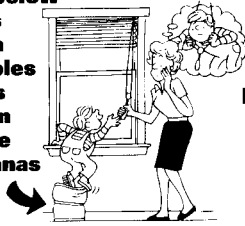

**Loops will appear when shade is in raised position
Se forma un lazo al subir la cortina plegadiza**



**Do not tie cords together
No ate juntos los cordones**

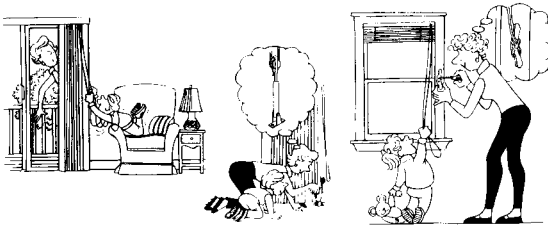

**Install a cord tension pulley or cord cleat
Instale una sujetacuerdas o una presilla para los cordones**

**EMERGENCY FIRST AID FOR STRANGULATION
PRIMEROS AUXILIOS DE URGENCIA EN CASOS DE ESTRANGULACION**



- Remove cord from child's neck
- Call 911 or Emergency Center
- Clear throat
- Check breathing and heart beat
- Begin CPR

- Quite el cordon del cuello del niño
- Llame al 911 o al Centro de Urgencias
- Desatore la garganta
- Compruebe la respiración y el latido del corazón
- Inicie la resucitación cardio pulmonar