

INSTALLATION INSTRUCTIONS

NO TOOLS MOUNTING SYSTEM

Honeycomb Shades

NOTE: The No Tools Mounting System will come with the shade installation brackets already attached. No drilling is necessary to install this shade. A Flat head screwdriver is needed to remove the No Tools Mounting System.

1. Install the No Tools Mounting System

Make sure mounting surface is level

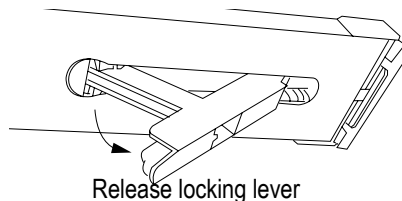
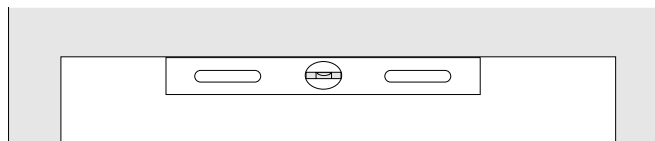

1a. Install the No Tools Mounting System - Placement and Width Adjustment

IMPORTANT If mounting on a smooth surface such as painted aluminum or tile you must apply the double sided adhesive (included) to the end caps to keep the mounting system secure. Remove release liner from one side of the adhesive and apply to both end caps and press firmly to adhere.

①

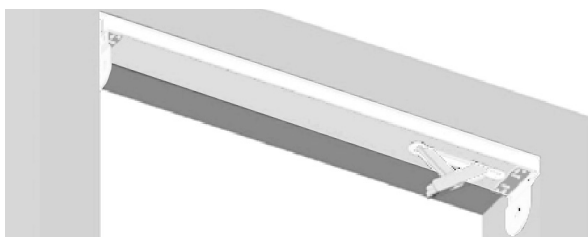

②

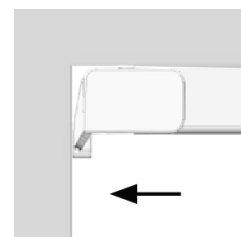
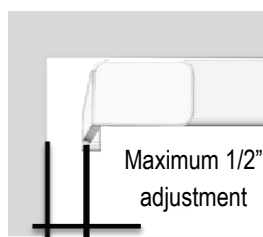

(1) Place the No Tools Mounting System in the window opening so that the end with the lever is up tight against the window casing. (2) If there is a gap at the non-lever end of the rail, simply slide the end cap until it touches the window casing. See END CAP ADJUSTMENT on page 2 if you accidentally pull the end cap out too far. If mounting on a smooth surface, remove the release liners from the double sided adhesive on the endcaps. Replace mounting system.

1b. Install the No Tools Mounting System - Lock in Place

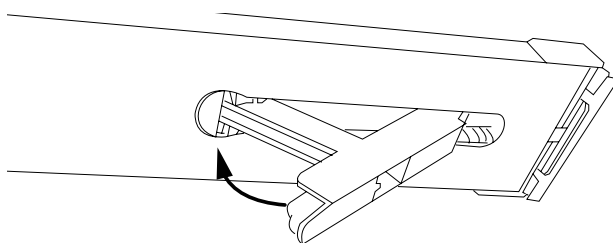

Make sure that the mounting system is level. Press up on the lever to lock the mounting system in place.

2. Install the Shade

Follow the instruction in the installation booklet that came with your shade to install the shade into the mounting brackets on the No Tools Mounting System.

3. Remove the No Tools Mounting System

IMPORTANT First, remove the shade from the No Tools mounting system following the instructions in the installation booklet that came with your shade. Hold the mounting system securely with one hand. Use a flat head screwdriver to pry open the locking lever.

CAUTION: Lever will release abruptly. Keep hand clear of lever.

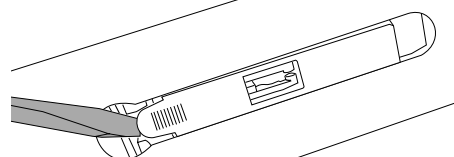

INSTALLATION INSTRUCTIONS

4. Adjusting Moveable End Cap

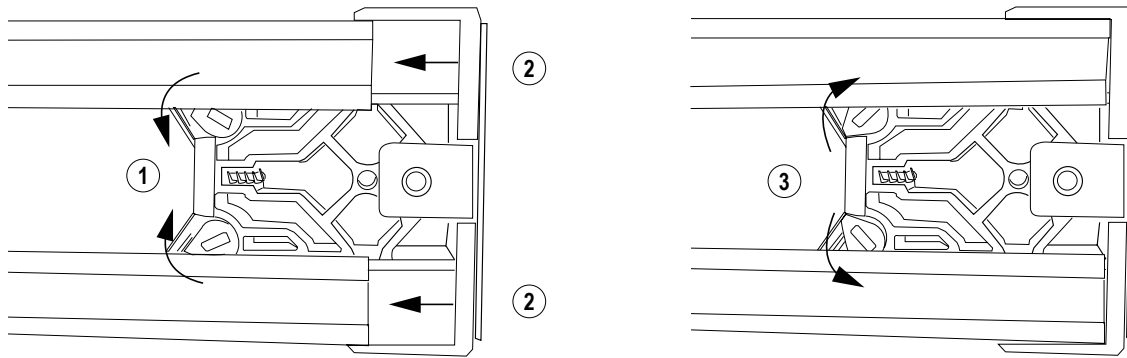

The moveable end cap is designed to only pull out with out tools. If for some reason the end cap needs to be compressed you will need a small flat head screw driver. (1) Use the screw driver to turn the locking tab release screws as shown. (2) Push the End Cap in. (3) Return the locking tabs to their original position.

Child Safety

⚠ WARNING/ADVERTENCIA	
5.1.3	Rev. 5/18 Print 5/18
	<p>Window Blind Cord Can STRANGLE Your Child. To prevent strangulation, purchase cordless products or products with inaccessible cords.</p> <p>La cuerda de la persiana puede ESTRANGULAR a su niño. Para evitar el estrangulamiento, compre alternativas cuerda o productos con cuerdas inaccesibles.</p>

