

## BASICS

A few simple tools are required:

- Measuring tape
- Carpenters Level
- Power drill with Phillips driver bit or Phillips head Screwdriver
- Flat Head Screwdriver

Additional fasteners other than those sent with your shading may be required depending on the mounting surface. Wallboard and plaster require the use of anchors such as expansion or toggle bolts. Brick, tile or stone need special plugs and drill bits. Remember to always pre-drill holes in wood to avoid splitting.

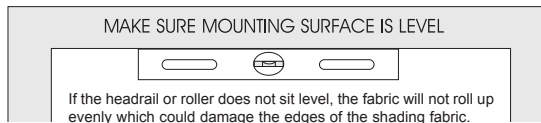
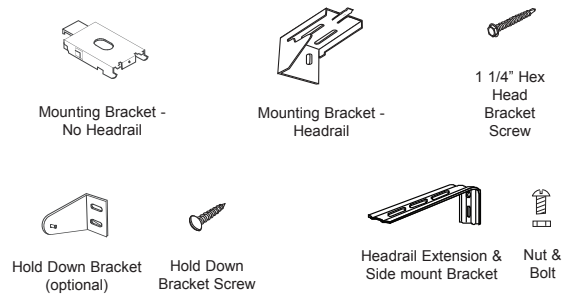

## Step 1. BRACKET INSTALLATION

The end brackets should be located with centerlines as noted in the illustrations. Depending on the width of the shading, necessary additional brackets may be evenly spaced between the two end brackets.

Shade width	# Brackets
Up to 40"	2
>40" - 72"	3
>72" - 84"	4
>84" - 96"	5

## Inside Mount

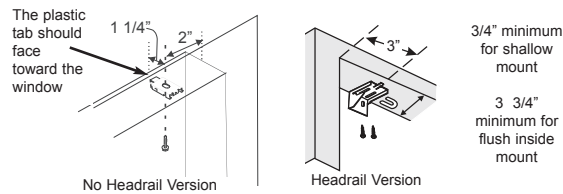

No headrail version: Make sure that the screw head is fully recessed inside the clear plastic part of the mounting bracket.

## Outside/Wall Mount

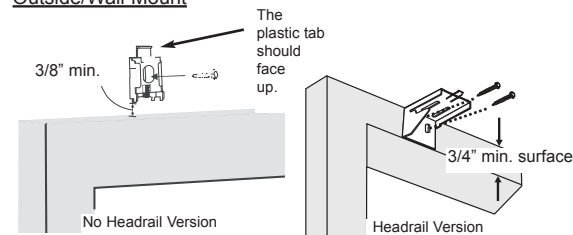

## Side Mount (optional)

Measure from window sill up to desired mounting position on each side of the window frame. Mark position. Mount Side Mount Brackets on each side of window frame as shown. Make sure to confirm that headrail will sit perfectly level. Once Side Mount Brackets are installed and properly positioned, attach the Standard Mounting Brackets using the nuts and bolts provided.

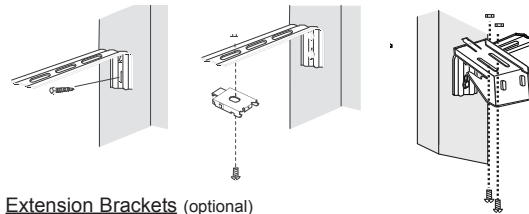

## Extension Brackets (optional)

Optional Extension Brackets are used to project the back of the shading up to 2 1/2 inches from the mounting surface. Attach the Standard Mounting Bracket to the Extension Bracket with the nut and bolt provided.

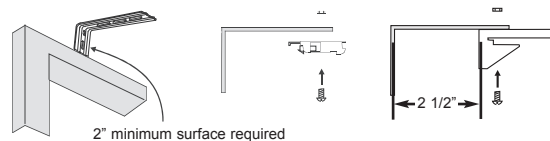

## Step 2. HANGING THE SHADE

### No Headrail Version

Inside Mount or Extension Bracket

Hook the rail onto the front of the bracket and rotate it until the back of the rail securely snaps into place.

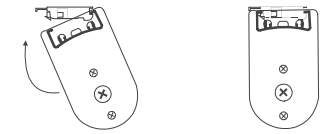

Outside/Wall Mount

Hook the rail onto the bottom of the bracket and rotate it until the back of the rail securely snaps into place.

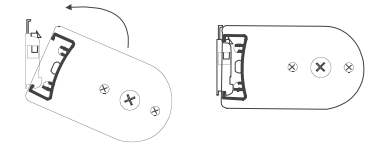

### Headrail Version

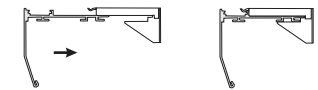

Push the rail back until it is fully engaged.

### Un-Install Shade - No headrail Inside Mount

To remove the shade, partially lower the shading and use a flat head screwdriver to press the clear tab on the mounting bracket. Rotate the shade to remove.

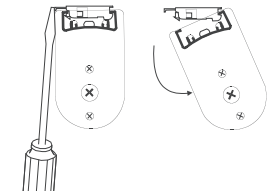

Outside/Wall Mount

Press down on clear tab and then rotate shade to release.

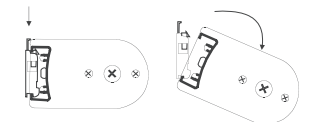

### Un-Install Headrail

To remove the shade, partially lower the shade and insert a flat head screwdriver as shown. Twist the screwdriver until the headrail disengages from the bracket.

